

ADDITION & ALTERATION SITE PLAN OF G+V STORIED RESIDENTIAL BUILDING AT PREMISES NO.-5/3, M.M.FEEDER ROAD, ARIADHA, KOLKATA-57, MOUZA-ARIADHA-KAMARHATI, HOLDING NO.-363, WARD NO.-11, C.S. DAG NOS.-3385(P) & 3314(P), KHATIAN NO.-1109, J.L. NO.-1, P.S.-BELGHARIA, DIST.-24PARGANAS (NORTH) UNDER KAMARHATI MUNICIPALITY.

AREA OF LAND = 18 KH.-4 CH.-08 SQ.FT. = 1221.93 SQM. = 13148 SQ.FT.

EXISTING GROUND FLOOR AREA (59.0%) = 720.91 SQ.M. = 7757 SQ.FT.
 EXISTING FIRST FLOOR AREA = 767.66 SQ.M. = 8260 SQ.FT.
 EXISTING SECOND FLOOR AREA = 767.66 SQ.M. = 8260 SQ.FT.
 EXISTING THIRD FLOOR AREA = 767.66 SQ.M. = 8260 SQ.FT.
 EXISTING FOURTH FLOOR AREA = 767.66 SQ.M. = 8260 SQ.FT.
 PROPOSED FIFTH FLOOR AREA (49.49%) = 604.83 SQ.M. = 6508 SQ.FT.



SCALE

TOTAL FLOOR AREA = 4396.38 SQ.M. = 47305 SQ.FT.

1:200

HEIGHT OF THE BUILDING 17.350 M FROM GROUND LEVEL.

NAME OF THE ASSESSEE:- (1) RUPBANI MANNA, (2) SUBRATA MANNA, (3) DEBABRATA MANNA, (4) KAKALI BANERJEE, (5) MITHU CHANDRA.

C.S. DAG NO.-3313 **SITE PLAN NO. 244/21-22**
 35'-1.5" (9487)

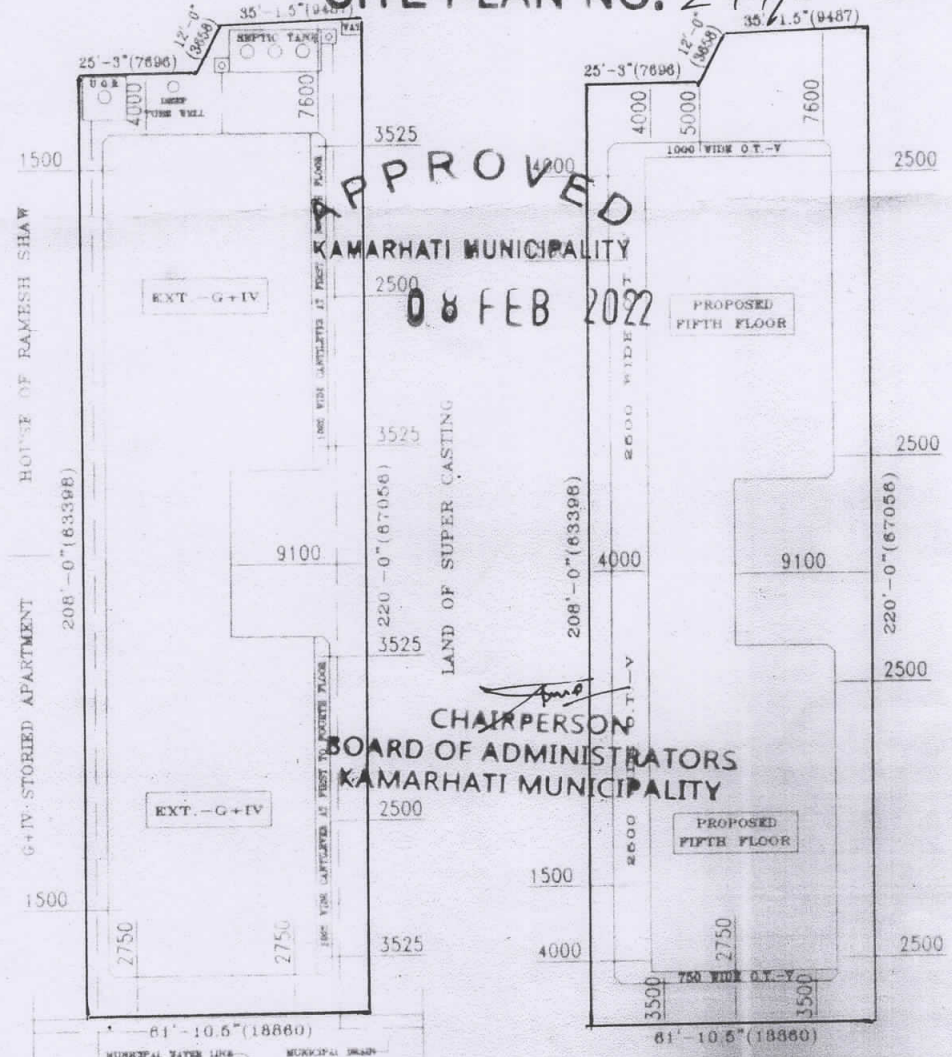

APPROVED
 KAMARHATI MUNICIPALITY

08 FEB 2022

CHAIRPERSON
 BOARD OF ADMINISTRATORS
 KAMARHATI MUNICIPALITY

PROP. SITE PLAN

SIGNATURE OF THE L.B.S.:

SIGNATURE OF THE OWNER/S:

1. *রাপানী মন্না*
2. *Subrata Manna*
3. *Subrata Manna*